

1. Download the “eduroam-renyi.crt” certificate from the following location:
<https://eduroam-guide.renyi.hu/>

2. Double click on the downloaded file, then click “Open”.

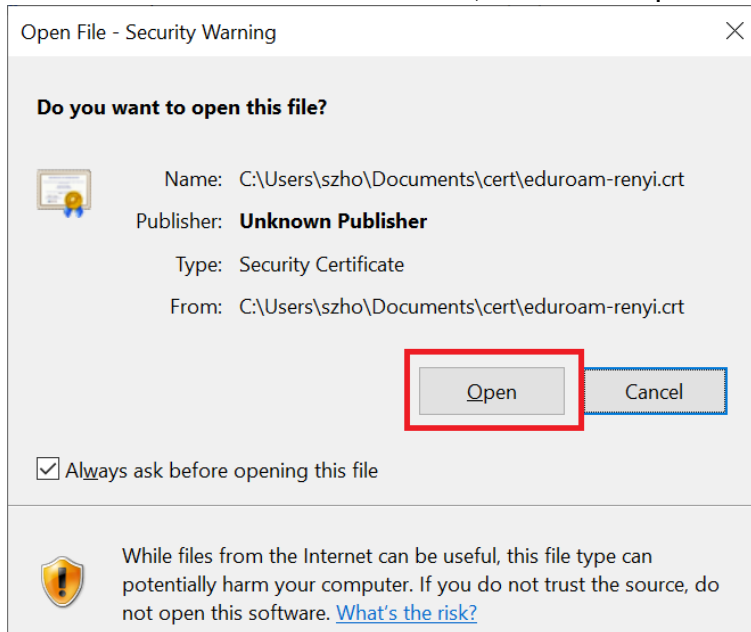

3. Click “Install Certificate...”.

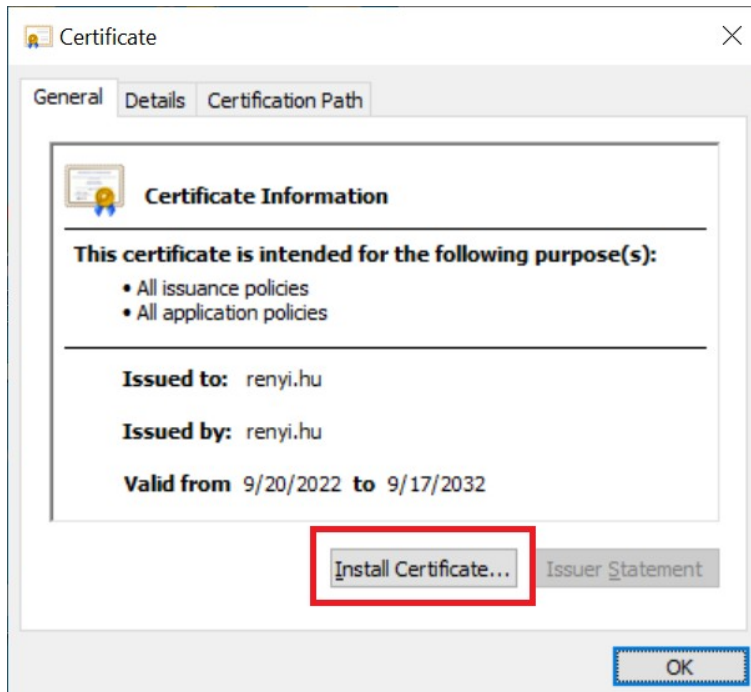

4. Choose “Local Machine”, then click “Next”.

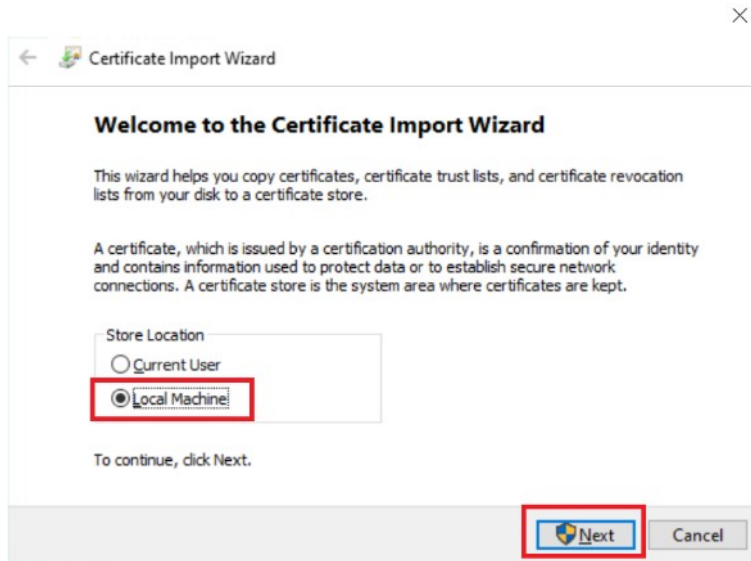

5. Choose “Place all certificates in the following store”, then click “Browse”.

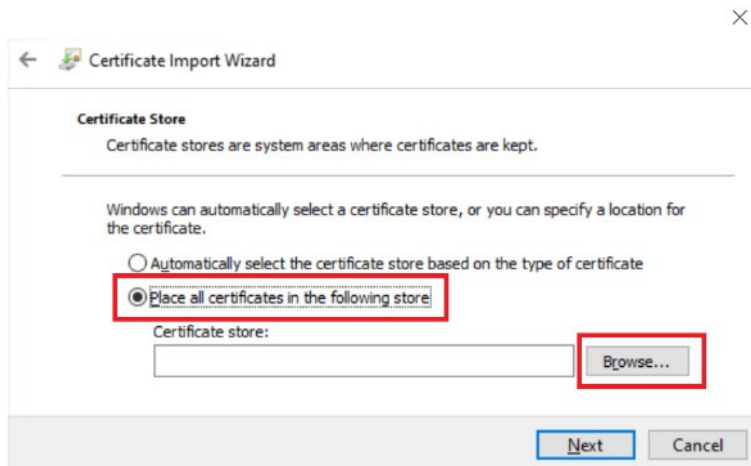

6. Choose “Trusted Root Certification Authorities”, then click “OK”.

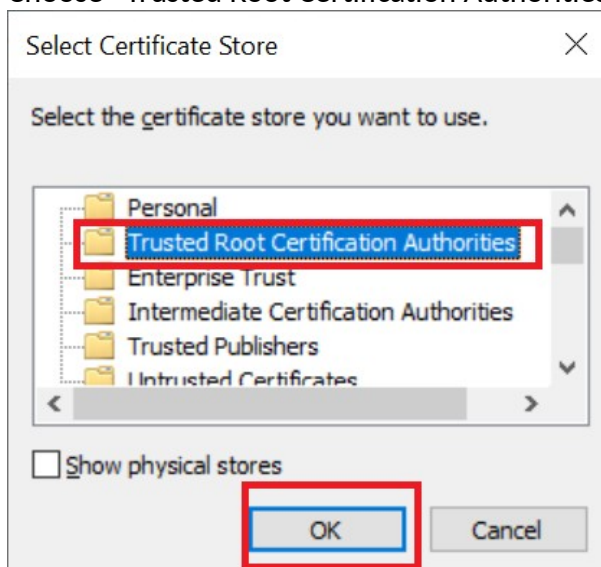

7. Click “Next”.

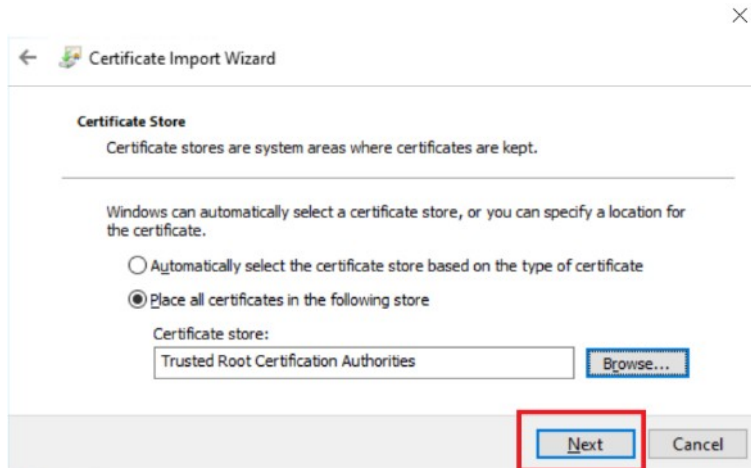

8. Click “Finish”.

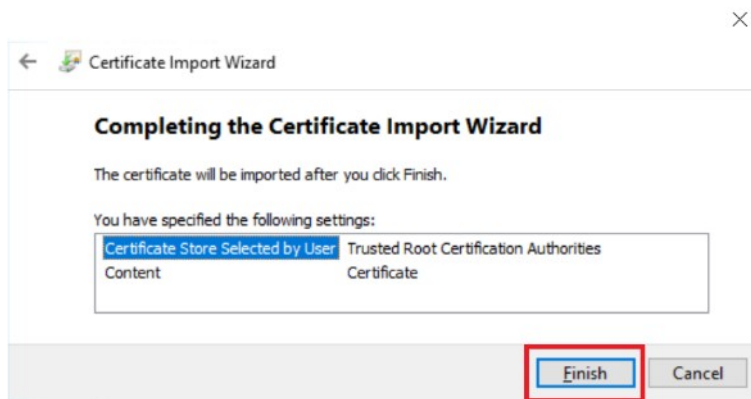

9. In case you previously had Eduroam configured on your device, click the wireless networks icon on the right side of the tray, then right click on “eduroam” and choose “Forget”. If you’re configuring Eduroam for the first time, proceed with #10.

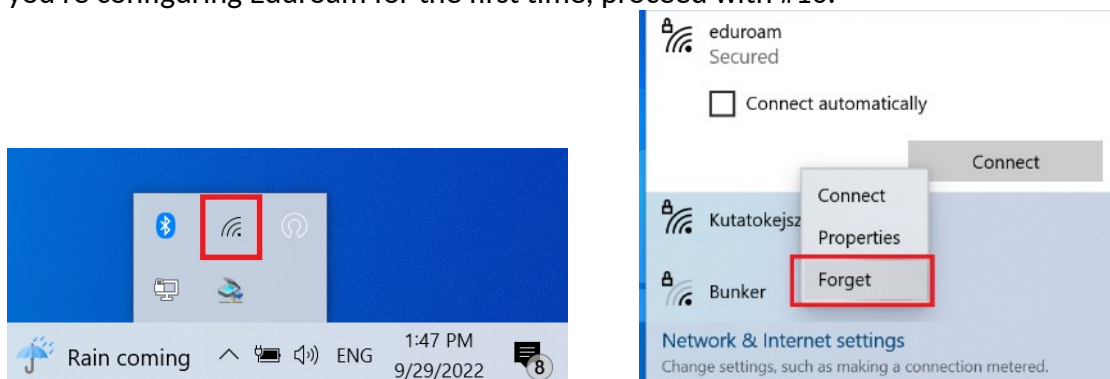

10. Right click on the networks icon, then choose “Open Network & Internet settings”.

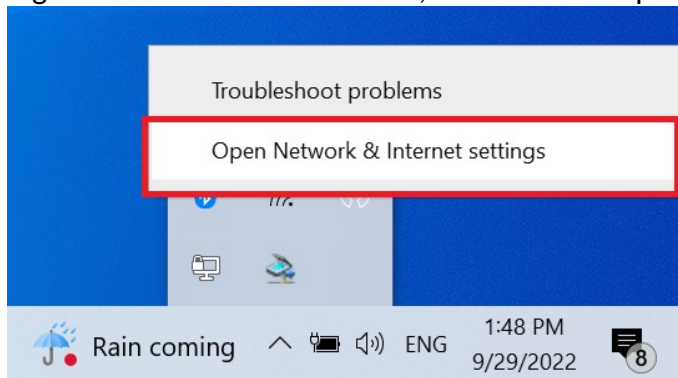

NOTE:WINDOWS 11 users press Windows key+R and type “control” press ENTER.

11. Open “Network and Sharing Center”.

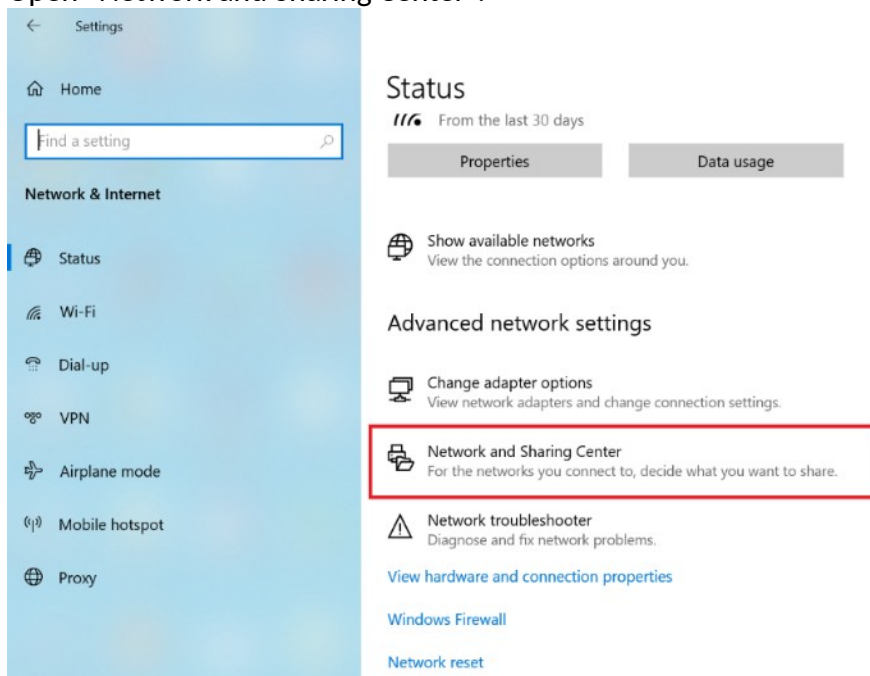

12. Click “Set up a new connection or network”.

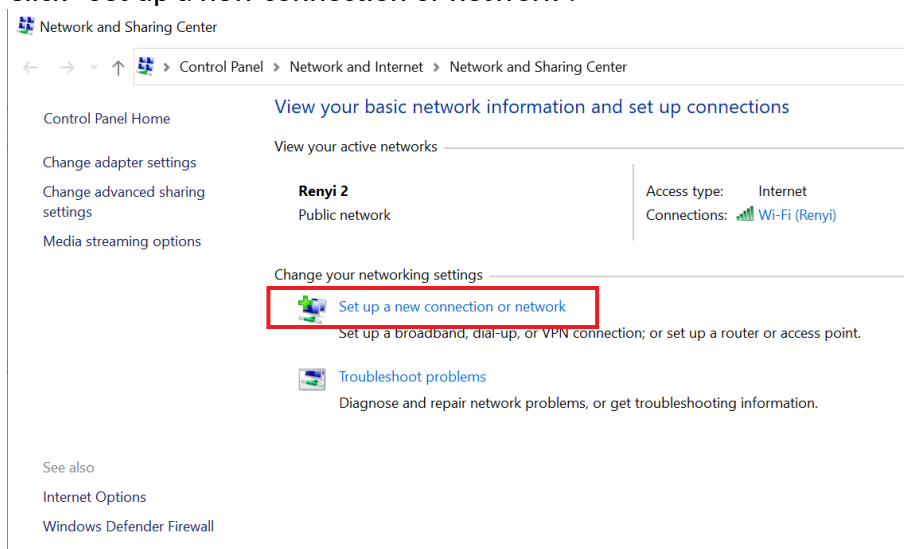

13. Choose “Manually connect to a wireless network” then click “Next”.

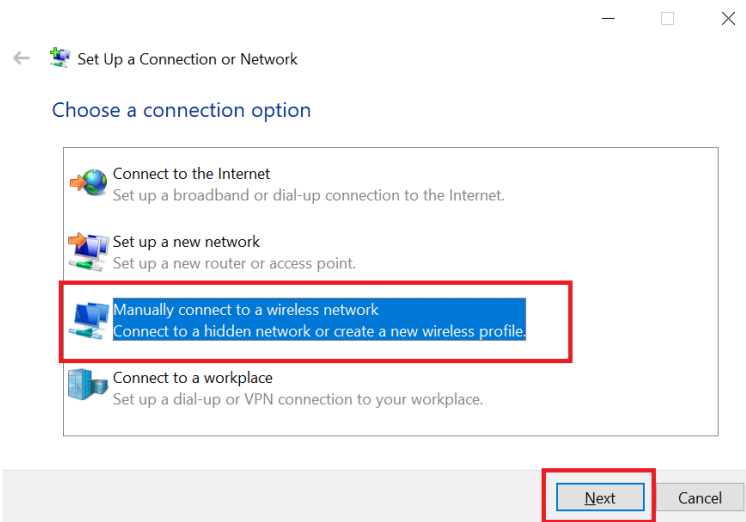

14. Set the following parameters, then click “Next”:

- Network name: eduroam
- Security type: WPA2-Enterprise

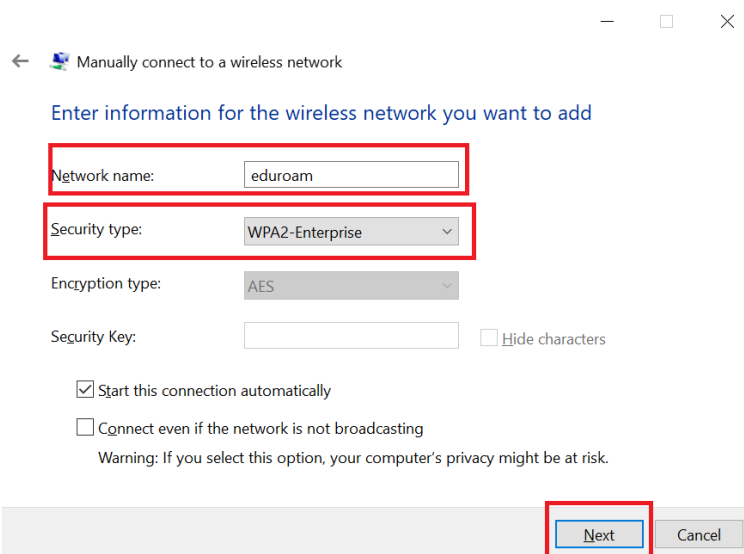

15. Choose “Change connection settings”.

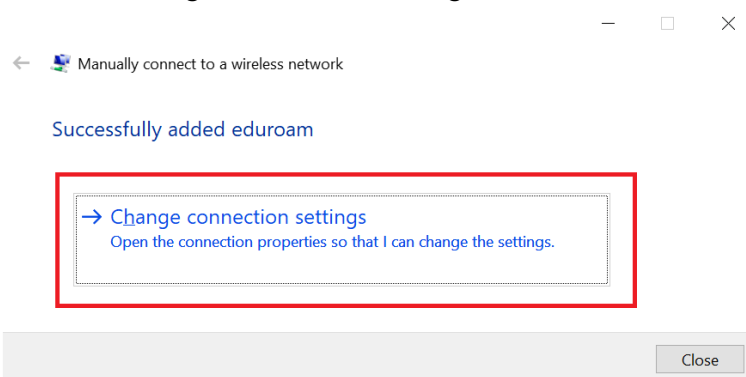

16. On the “Security” tab, under “Choose a network authentication method” choose “Microsoft: Protected EAP (PEAP)”, then click “Settings”.

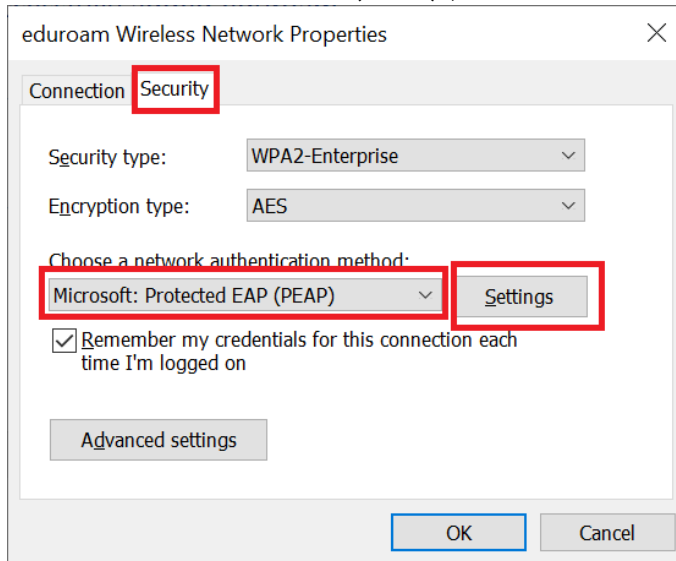

17. Tick “Verify the server’s identity by validating the certificate” and “Connect to these servers”; under the latter, type “renyi.hu”. Under “Trusted Root Certificate Authorities”, tick “renyi.hu”. Under “Select Authentication Method”, select “Secured password (EAP-MSCHAPv2)”, then click “OK”.

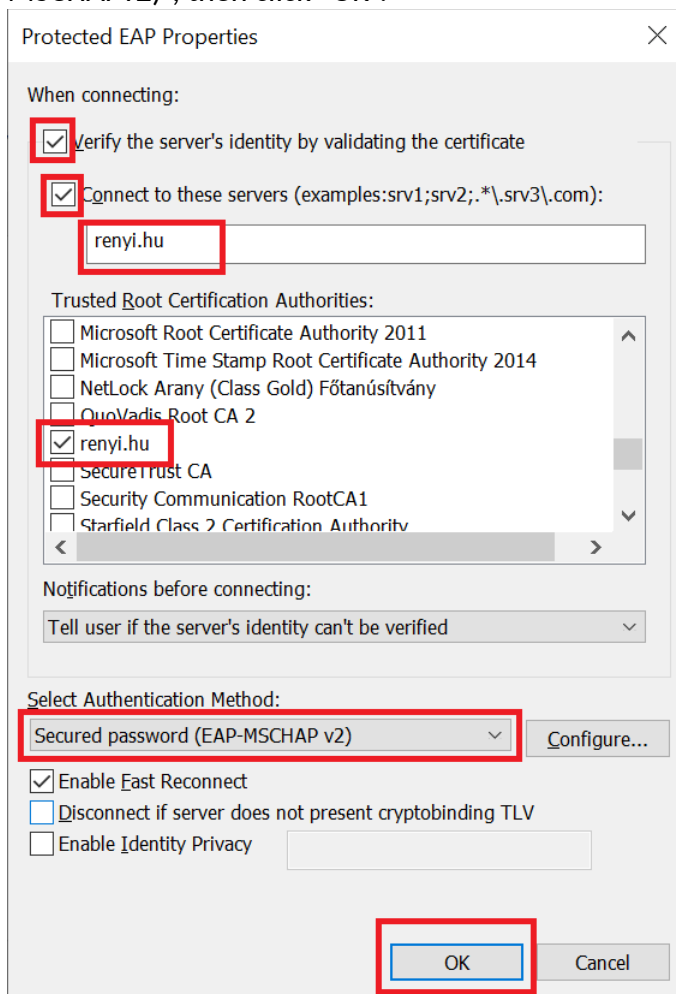

18. Click “Advanced settings”.

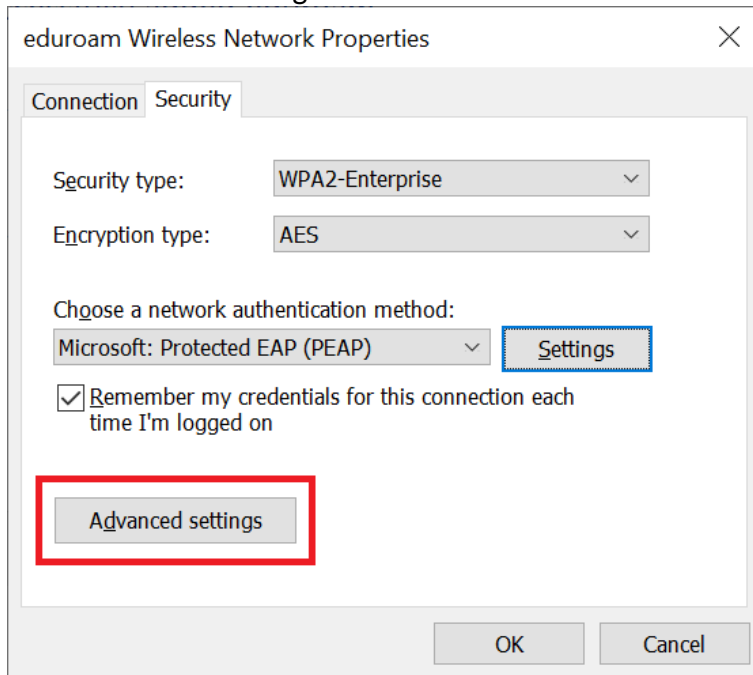

19. Tick “Specify authentication mode”, select “User authentication”, then click “Save credentials”.

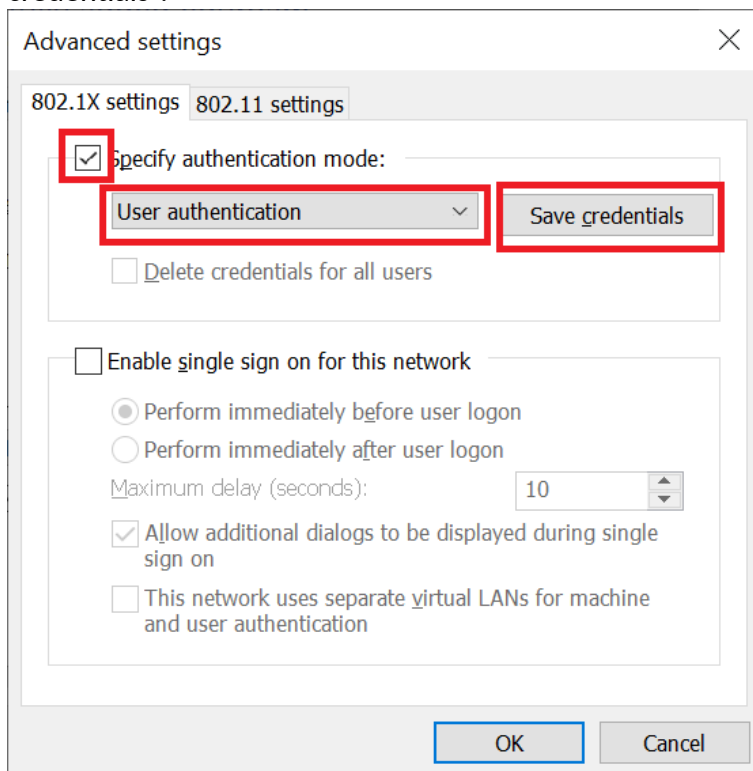

20. Type your Eduroam credentials (username@renyi.hu / password), then click “OK”.

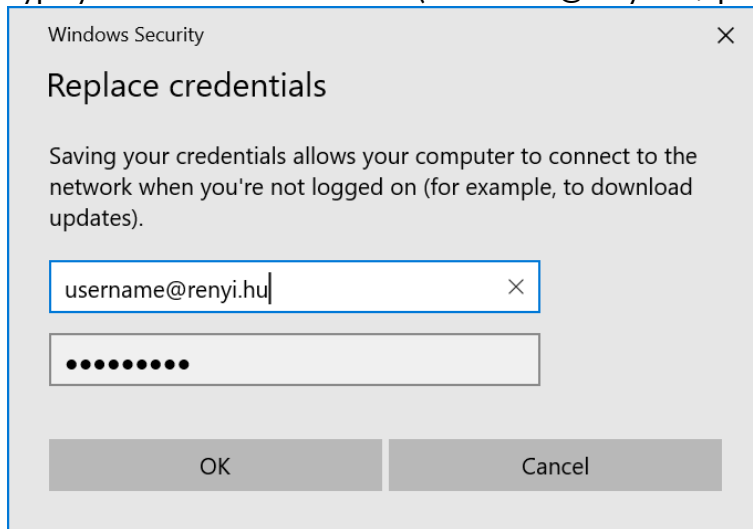

Windows Security

Replace credentials

Saving your credentials allows your computer to connect to the network when you're not logged on (for example, to download updates).

username@renyi.hu

.....

OK Cancel

21. Click “OK”.

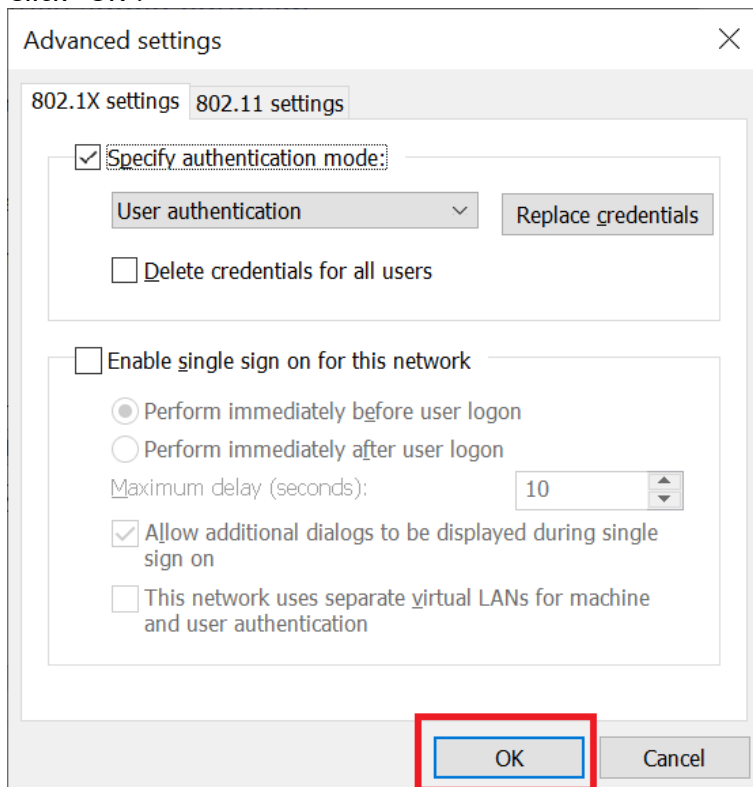

Advanced settings

802.1X settings 802.11 settings

Specify authentication mode:

User authentication Replace credentials

Delete credentials for all users

Enable single sign on for this network

Perform immediately before user logon

Perform immediately after user logon

Maximum delay (seconds): 10

Allow additional dialogs to be displayed during single sign on

This network uses separate virtual LANs for machine and user authentication

OK Cancel

22. Click “OK” again.

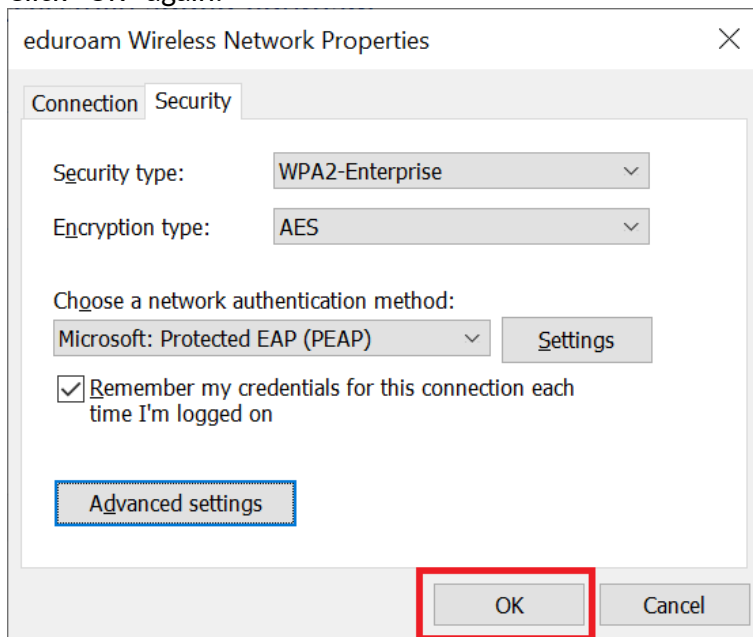

23. You can connect to the “eduroam” wireless network.

